

Legend

- Tract Boundary
- Non-Cropland
- Cropland
- CRP

Wetland Determination Identifiers

- Restricted Use
- Limited Restrictions
- Exempt from Conservation Compliance Provisions

2024 Program Year
Map Created March 09, 2024

Farm **4698**
Tract **255**

Tract Cropland Total: 77.31 acres

United States Department of Agriculture (USDA) Farm Service Agency (FSA) maps are for FSA Program administration only. This map does not represent a legal survey or reflect actual ownership; rather it depicts the information provided directly from the producer and/or National Agricultural Imagery Program (NAIP) imagery. The producer accepts the data 'as is' and assumes all risks associated with its use. USDA-FSA assumes no responsibility for actual or consequential damage incurred as a result of any user's reliance on this data outside FSA Programs. Wetland identifiers do not represent the size, shape, or specific determination of the area. Refer to your original determination (CPA-026 and attached maps) for exact boundaries and determinations or contact USDA Natural Resources Conservation Service (NRCS).

Soils Map

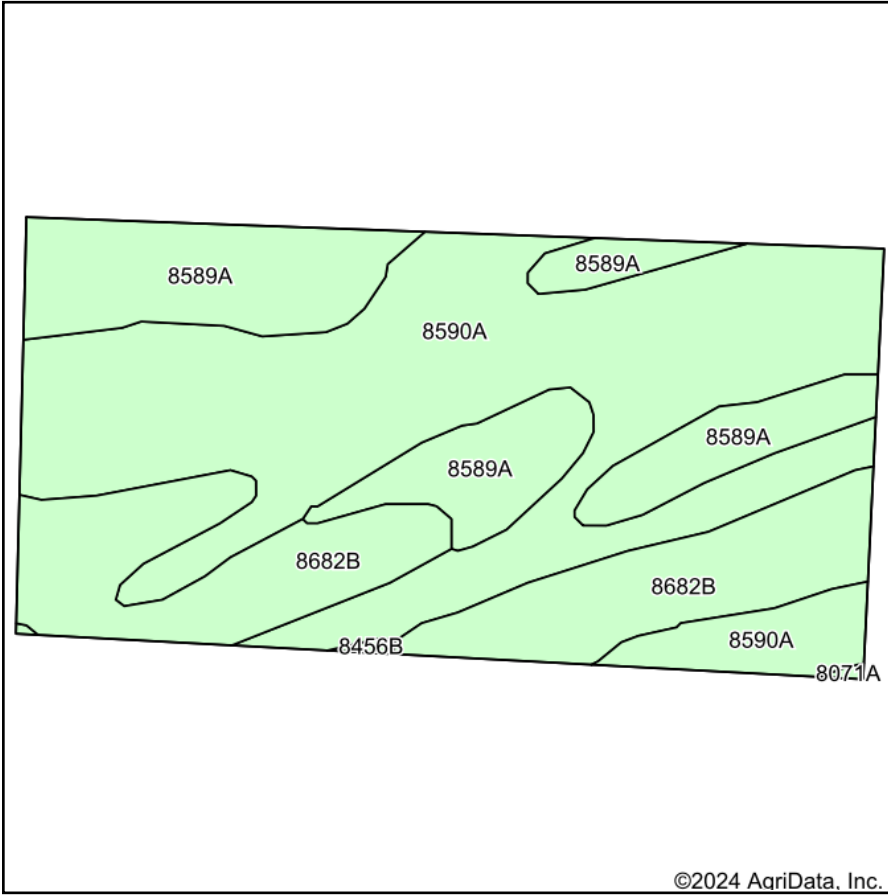

Soils data provided by USDA and NRCS.

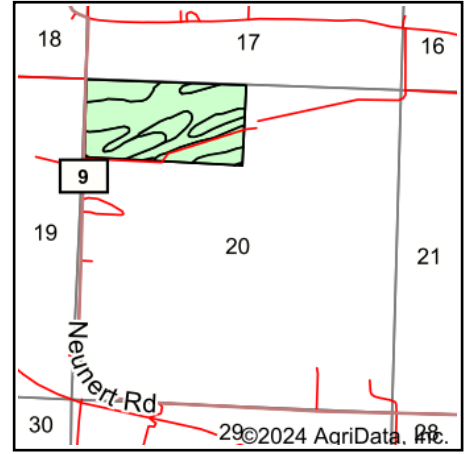

State: **Illinois**
 County: **Jackson**
 Location: **20-9S-4W**
 Township: **Fountain Bluff**
 Acres: **79.23**
 Date: **9/6/2024**



Maps Provided By:



© AgriData, Inc. 2023

www.AgriDataInc.com



©2024 AgriData, Inc.

Area Symbol: IL077, Soil Area Version: 23

Code	Soil Description	Acres	Percent of field	Corn Bu/A	Soybeans Bu/A	Wheat Bu/A	Crop productivity index for optimum management	*n NCCPI Soybeans
**8590A	Cairo silty clay, 0 to 2 percent slopes, occasionally flooded	42.19	53.3%	**158	**53	**60	**118	59
**8682B	Medway silty clay loam, 1 to 6 percent slopes, occasionally flooded	18.72	23.6%	**172	**56	**68	**128	69
**8589A	Bowdre silty clay, 0 to 3 percent slopes, occasionally flooded	18.07	22.8%	**150	**47	**57	**110	75
**8456B	Ware loam, 1 to 6 percent slopes, occasionally flooded	0.17	0.2%	**153	**49	**61	**114	54
**8071A	Darwin silty clay, 0 to 2 percent slopes, occasionally flooded	0.08	0.1%	**148	**50	**60	**111	46
Weighted Average				159.5	52.3	61.2	118.5	*n 65

Table: Optimum Crop Productivity Ratings for Illinois Soil EFOTG are sourced from Bulletin 811 calculated Map Unit Base Yield Indices, and adjusted (Adj) for slope, erosion, flooding, and surface texture. Publication Date: 02-08-2023

Crop yields and productivity (B811 EFOTG) are maintained at the following USDA web site: 2023 Illinois Soil Productivity and Yield Indices: <https://efotg.sc.egov.usda.gov/#/state/IL/documents/section=2&folder=52809>

** Base indexes from Bulletin 811 adjusted for slope, erosion, flooding, and surface texture according to the IL Soils EFOTG

*n: The aggregation method is "Weighted Average using all components"

Topography Map

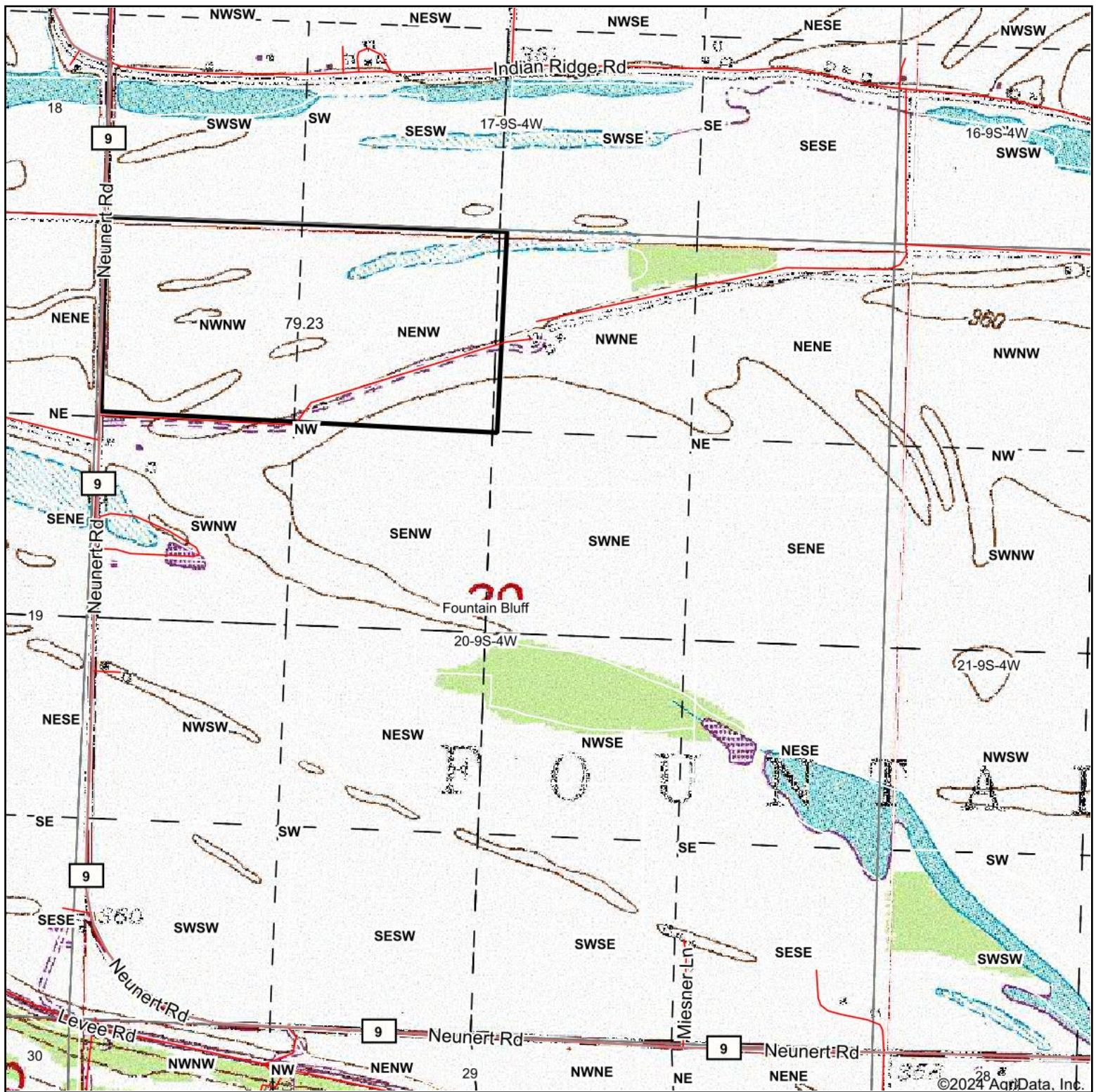

Map Center: 37° 43' 53.29, -89° 34' 20.62

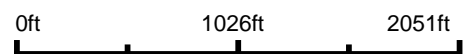

20-9S-4W
Jackson County
Illinois



9/6/2024



Maps Provided By:



© AgriData, Inc. 2023 www.AgridataInc.com

Field borders provided by Farm Service Agency as of 5/21/2008.



Abbreviated 156 Farm Record

Operator Name : HEINS BROTHERS FARMS
CRP Contract Number(s) : None
Recon ID : 17-077-2011-13
Transferred From : None
ARCPLC G//F Eligibility : Eligible

Farm Land Data

Farmland	Cropland	DCP Cropland	WBP	EWP	WRP	GRP	Sugarcane	Farm Status	Number Of Tracts
182.09	170.96	171.56	0.00	0.00	0.00	0.00	0.0	Active	2
State Conservation	Other Conservation	Effective DCP Cropland	Double Cropped		CRP	MPL	DCP Ag.Rel. Activity	SOD	
0.00	0.00	171.56	0.00		0.00	0.00	0.60	0.00	

Crop Election Choice

ARC Individual	ARC County	Price Loss Coverage
None	CORN, SOYBN	None

DCP Crop Data

Crop Name	Base Acres	CCC-505 CRP Reduction Acres	PLC Yield	HIP
Corn	42.06	0.00	116	
Soybeans	122.04	0.00	45	
TOTAL	164.10	0.00		

NOTES

--

Tract Number : 255

Description : C8-3 SEC 20 T9SR4W
FSA Physical Location : ILLINOIS/JACKSON
ANSI Physical Location : ILLINOIS/JACKSON
BIA Unit Range Number :
HEL Status : NHEL: No agricultural commodity planted on undetermined fields
Wetland Status : Wetland determinations not complete
WL Violations : None
Owners : A & A HEINS FARM, BRENDA HELLMER-TODD, RONALD E HEINS, ROBERT L SUMNER
Other Producers : None
Recon ID : None

Tract Land Data

Farm Land	Cropland	DCP Cropland	WBP	EWP	WRP	GRP	Sugarcane
80.03	77.31	77.91	0.00	0.00	0.00	0.00	0.0

Abbreviated 156 Farm Record

Tract 255 Continued ...

State Conservation	Other Conservation	Effective DCP Cropland	Double Cropped	CRP	MPL	DCP Ag. Rel Activity	SOD
0.00	0.00	77.91	0.00	0.00	0.00	0.60	0.00

DCP Crop Data

Crop Name	Base Acres	CCC-505 CRP Reduction Acres	PLC Yield
Corn	19.10	0.00	116
Soybeans	55.42	0.00	45
TOTAL	74.52	0.00	

NOTES

--

Tract Number : 256

Description : C8-3 SEC 20 T9SR4W
FSA Physical Location : ILLINOIS/JACKSON
ANSI Physical Location : ILLINOIS/JACKSON
BIA Unit Range Number :
HEL Status : NHEL: No agricultural commodity planted on undetermined fields
Wetland Status : Wetland determinations not complete
WL Violations : None
Owners : RONALD E HEINS, A & A HEINS FARM, BRENDA HELLMER-TODD, ROBERT L SUMNER
Other Producers : None
Recon ID : None

Tract Land Data

Farm Land	Cropland	DCP Cropland	WBP	EWP	WRP	GRP	Sugarcane
102.06	93.65	93.65	0.00	0.00	0.00	0.00	0.0
State Conservation	Other Conservation	Effective DCP Cropland	Double Cropped	CRP	MPL	DCP Ag. Rel Activity	SOD
0.00	0.00	93.65	0.00	0.00	0.00	0.00	0.00

DCP Crop Data

Crop Name	Base Acres	CCC-505 CRP Reduction Acres	PLC Yield
Corn	22.96	0.00	116
Soybeans	66.62	0.00	45
TOTAL	89.58	0.00	

NOTES

--

ILLINOIS
JACKSON

Form: FSA-156EZ



United States Department of Agriculture
Farm Service Agency

Abbreviated 156 Farm Record

FARM : 4698

Prepared : 9/6/24 11:10 AM CST

Crop Year : 2024

In accordance with Federal civil rights law and U.S. Department of Agriculture (USDA) civil rights regulations and policies, the USDA, its Agencies, offices, and employees, and institutions participating in or administering USDA programs are prohibited from discriminating based on race, color, national origin, religion, sex, gender identity (including gender expression), sexual orientation, disability, age, marital status, family/parental status, income derived from a public assistance program, political beliefs, or reprisal or retaliation for prior civil rights activity, in any program or activity conducted or funded by USDA (not all bases apply to all programs). Remedies and complaint filing deadlines vary by program or incident.

Persons with disabilities who require alternative means of communication for program information (e.g., Braille, large print, audiotape, American Sign Language, etc.) should contact the responsible Agency or USDA's TARGET Center at (202) 720-2600 (voice and TTY) or contact USDA through the Federal Relay Service at (800) 877-8339. Additionally, program information may be made available in languages other than English.

To file a program discrimination complaint, complete the USDA Program Discrimination Complaint Form, AD-3027, found online at http://www.ascr.usda.gov/complaint_filing_cust.html and at any USDA office or write a letter addressed to USDA and provide in the letter all of the information requested in the form. To request a copy of the complaint form, call (866) 632-9992. Submit your completed form or letter to USDA by: (1) mail: U.S. Department of Agriculture Office of the Assistant Secretary for Civil Rights 1400 Independence Avenue, SW Washington, D.C. 20250-9410; (2) fax: (202) 690-7442; or (3) e-mail: program.intake@usda.gov. USDA is an equal opportunity provider, employer, and lender.