

Aerial Map



Map Center: 38° 14' 24.25, -90° 12' 40.11



28-3S-10W
Monroe County
Illinois



10/8/2021

Maps Provided By:
 **surety**[®]
CUSTOMIZED ONLINE MAPPING
© AgriData, Inc. 2021 www.AgriDataInc.com

Field borders provided by Farm Service Agency as of 5/21/2008.

Soils Map

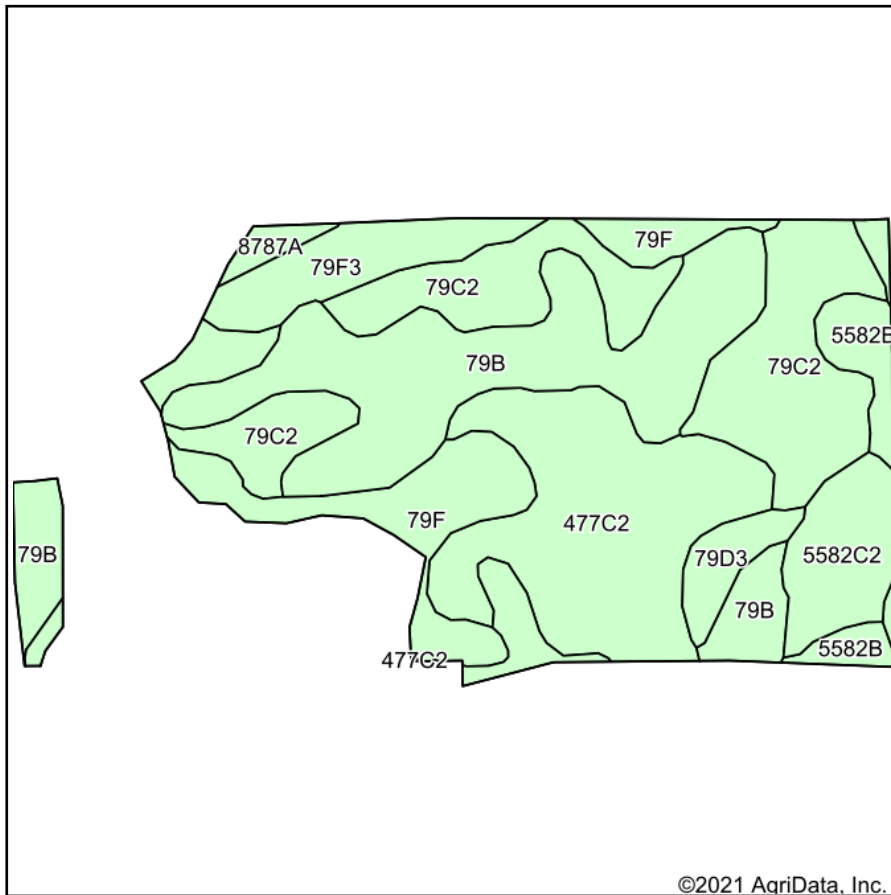

Soils data provided by USDA and NRCS.

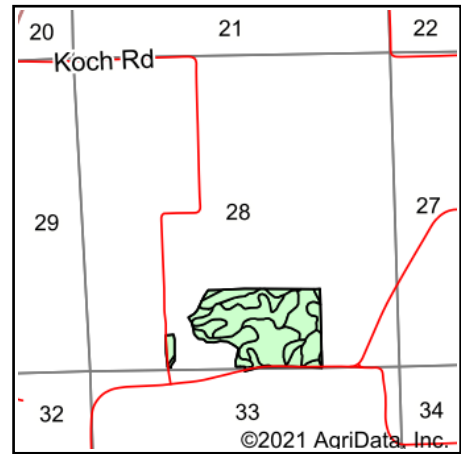

State: **Illinois**
 County: **Monroe**
 Location: **28-3S-10W**
 Township: **Precinct 23**
 Acres: **59.39**
 Date: **10/8/2021**



Maps Provided By:



© AgriData, Inc. 2021

www.AgriDataInc.com



Area Symbol: IL133, Soil Area Version: 13

Code	Soil Description	Acres	Percent of field	Corn Bu/A	Soybeans Bu/A	Wheat Bu/A	Grass-legume e hay, T/A	Crop productivity index for optimum management
**79B	Menfro silt loam, 2 to 5 percent slopes	16.99	28.6%	**163	**50	**62	0.00	**119
**79C2	Menfro silt loam, 5 to 10 percent slopes, eroded	12.70	21.4%	**153	**47	**59	0.00	**112
**477C2	Winfield silt loam, 5 to 10 percent slopes, eroded	11.60	19.5%	**151	**47	**59	0.00	**111
**79F	Menfro silt loam, 18 to 35 percent slopes	7.14	12.0%	**117	**36	**45	0.00	**85
5582C2	Homen silt loam, karst, 5 to 12 percent slopes, eroded	3.40	5.7%	150	47	56	0.00	109
**79F3	Menfro silty clay loam, 18 to 35 percent slopes, severely eroded	3.34	5.6%	**97	**30	**37	0.00	**71
5582B	Homen silt loam, karst, 2 to 5 percent slopes	2.18	3.7%	150	47	56	0.00	109
**79D3	Menfro silty clay loam, 10 to 18 percent slopes, severely eroded	1.46	2.5%	**134	**41	**51	0.00	**97
8787A	Banlic silt loam, 0 to 2 percent slopes, occasionally flooded	0.58	1.0%	142	47	56	4.64	106
Weighted Average				147.1	45.4	56.4	0.05	107.5

Table: Optimum Crop Productivity Ratings for Illinois Soil by K.R. Olson and J.M. Lang, Office of Research, ACES, University of Illinois at Champaign-Urbana. Version: 1/2/2012 Amended Table S2 B811

Crop yields and productivity indices for optimum management (B811) are maintained at the following NRES web site: <http://soilproductivity.nres.illinois.edu/>

** Indexes adjusted for slope and erosion according to Bulletin 811 Table S3

e Soils in the well drained group were not rated for grass-legume and are shown with a zero "0".

Soils data provided by USDA and NRCS. Soils data provided by University of Illinois at Champaign-Urbana.

Topography Map

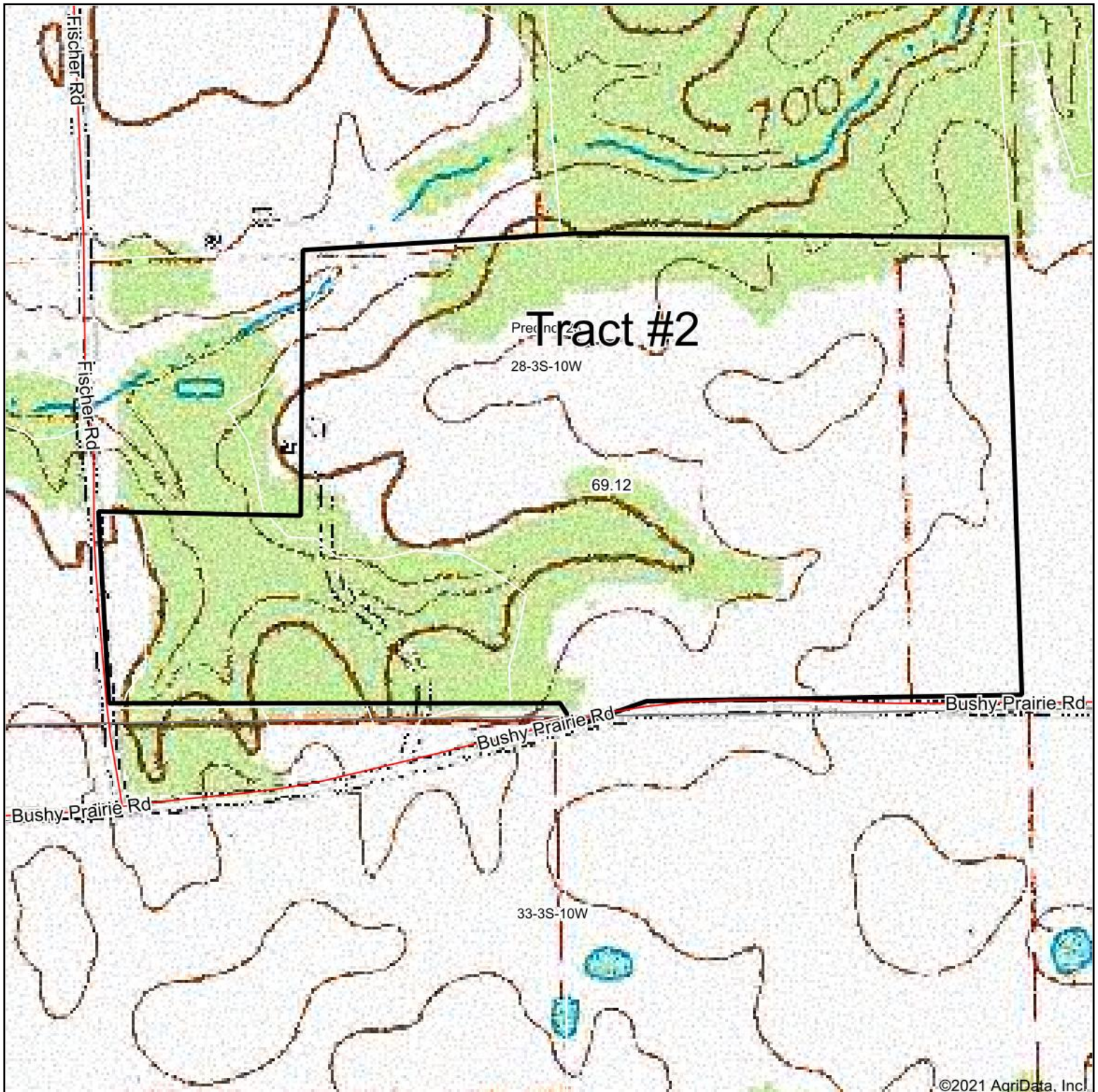

map center: 38° 14' 24.25, -90° 12' 40.11

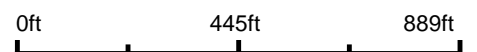

28-3S-10W
Monroe County
Illinois

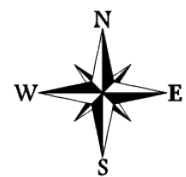

10/8/2021



Maps Provided By:



© AgriData, Inc. 2021

www.AgriDataInc.com