

Aerial Map

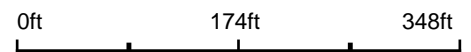

©2021 AgriData, Inc.

Map Center: 37° 40' 17.52, -88° 36' 54.55



12-10S-5E
Saline County
Illinois

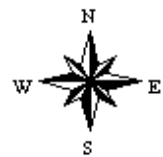

4/28/2021



© AgriData, Inc. 2021 www.AgriDataInc.com

Field borders provided by Farm Service Agency as of 5/21/2008.

Soils Map

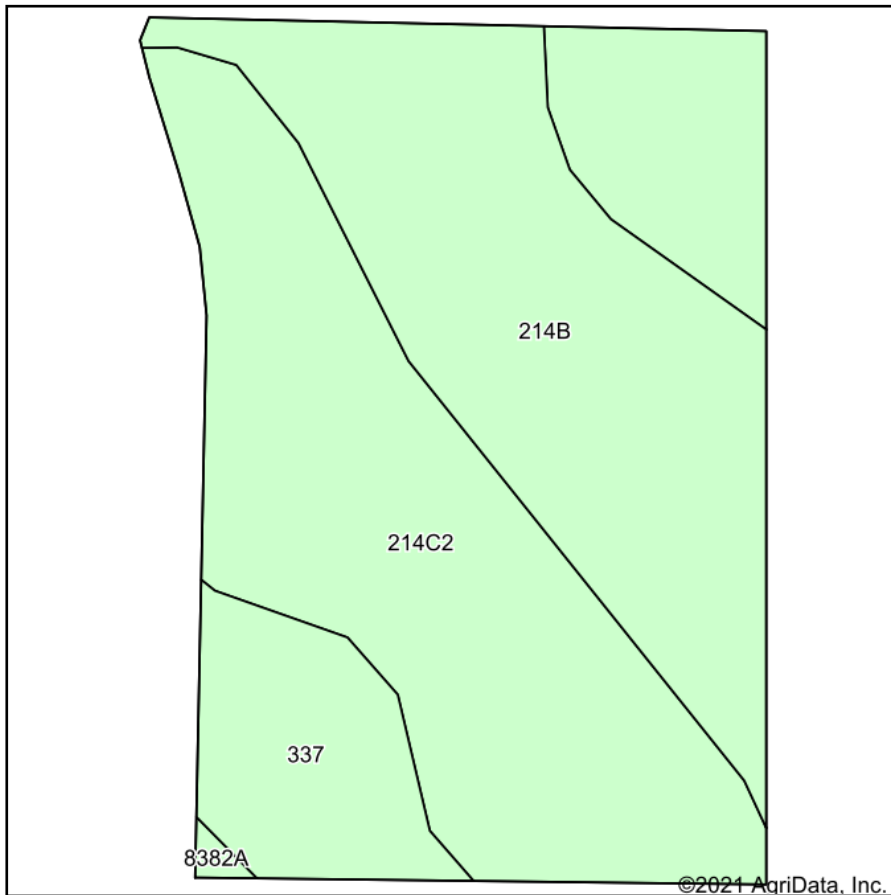

Soils data provided by USDA and NRCS.

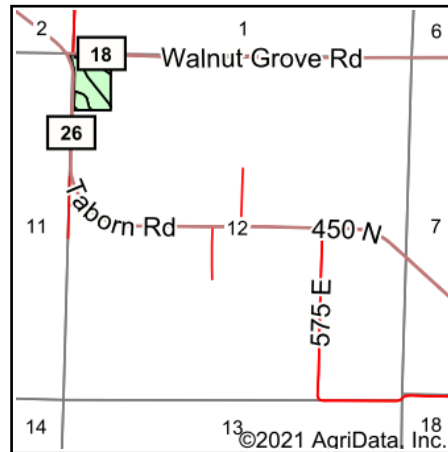

State: **Illinois**
 County: **Saline**
 Location: **12-10S-5E**
 Township: **Carrier Mills**
 Acres: **11.45**
 Date: **4/28/2021**



Maps Provided By:

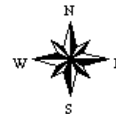

Area Symbol: IL165, Soil Area Version: 15

| Code | Soil Description | Acres | Percent of field | Corn Bu/A | Soybeans Bu/A | Wheat Bu/A | Crop productivity index for optimum management |
|-------------------------|--|-------|------------------|--------------|---------------|-------------|--|
| **214C2 | Hosmer silt loam, 5 to 10 percent slopes, eroded | 5.87 | 51.3% | **126 | **41 | **52 | **95 |
| **214B | Hosmer silt loam, 2 to 5 percent slopes | 4.33 | 37.8% | **139 | **46 | **57 | **104 |
| 337 | Creal silt loam | 1.25 | 10.9% | 151 | 47 | 59 | 110 |
| Weighted Average | | | | 133.6 | 43.5 | 54.7 | 100 |

Table: Optimum Crop Productivity Ratings for Illinois Soil by K.R. Olson and J.M. Lang, Office of Research, ACES, University of Illinois at Champaign-Urbana. Version: 1/2/2012 Amended Table S2 B811

Crop yields and productivity indices for optimum management (B811) are maintained at the following NRES web site: <http://soilproductivity.nres.illinois.edu/>

** Indexes adjusted for slope and erosion according to Bulletin 811 Table S3

Soils data provided by USDA and NRCS. Soils data provided by University of Illinois at Champaign-Urbana.

Topography Map

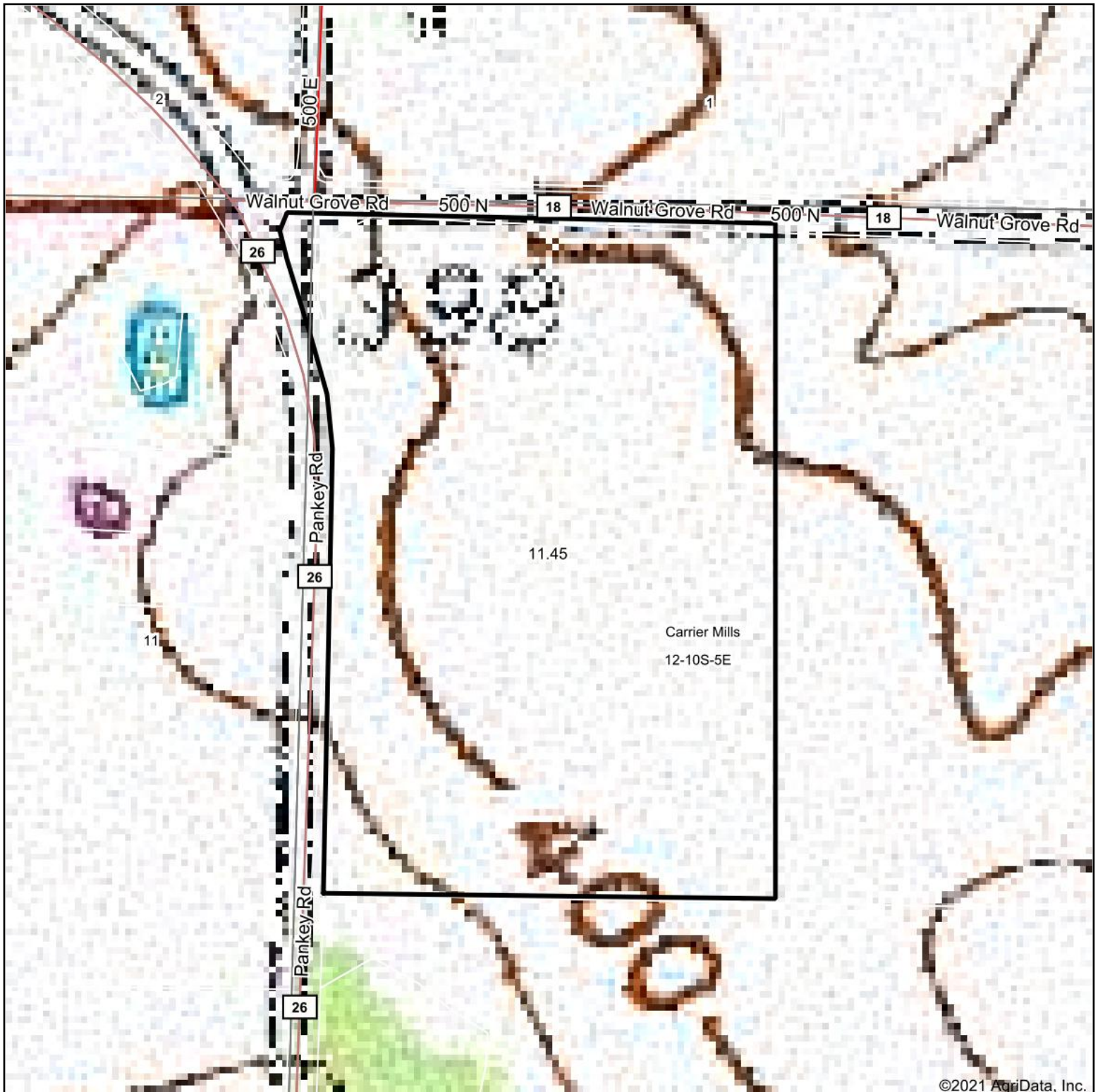

©2021 AgriData, Inc.

map center: 37° 40' 17.61, -88° 36' 54.5

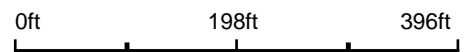

12-10S-5E
Saline County
Illinois

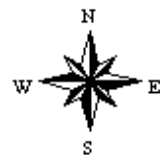

Maps Provided By:

CUSTOMIZED ONLINE MAPPING
© AgriData, Inc. 2021 www.AgriDataInc.com

4/28/2021