



**All Measurements are
For FSA Programs Only
Wetland Determination Identifiers**

- Restricted Use
- ▼ Limited Restrictions
- Exempt from Conservation Compliance Provisions

Disclaimer: Wetland identifiers do not represent the size, shape or specific determination of the area. Refer to your original determination (CPA-026 and attached maps) for exact wetland boundaries and determinations, or contact NRCS.

Vernon Co. FSA
 wht=wheat-SRW-Gr
 corn=Corn-Yel-Gr
 soy=Soybeans-Common-Gr
 milo=Sorghum-GRS-Gr
 gz=Mixfg-LGM-Gz
 hay=Mixfg-LGM-Fg
 LS=Mixfg-LGM-LS
 all fields are NI
 *Unless notated on Map

1 inch equals 648 feet

Program Year: 2021
 Created: 12/2/2020
 Flown: 2018-10-22

- clu
- crp
- plss

**Farm 8478
Tract 8856**



Soils Map

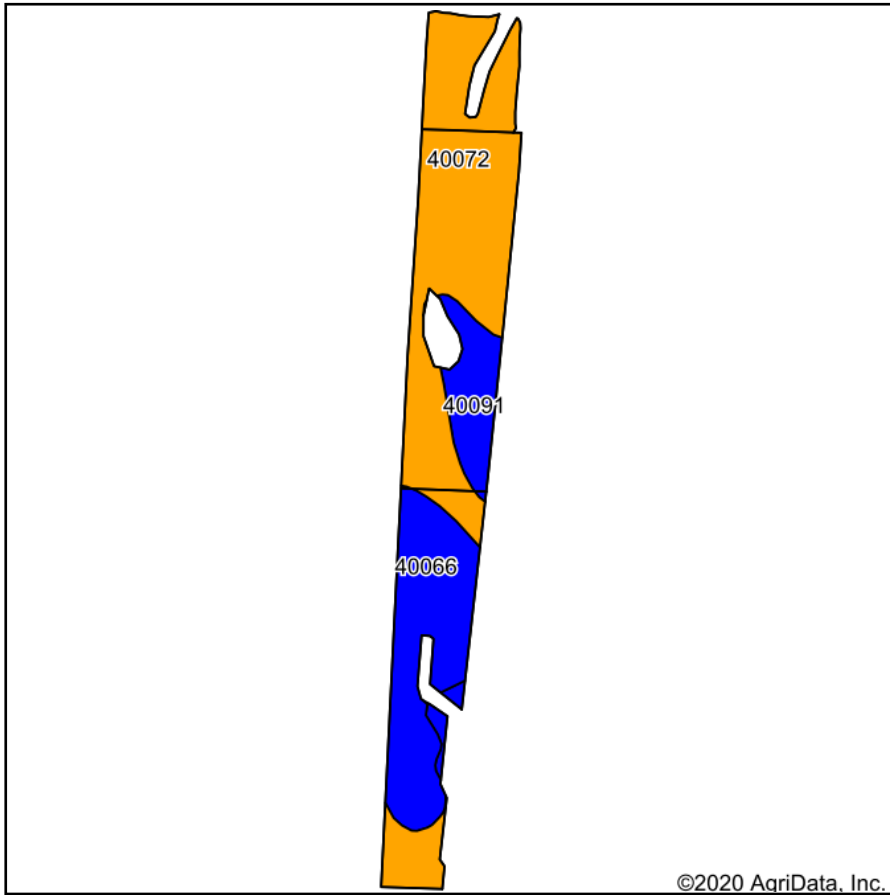

Soils data provided by USDA and NRCS.

©2020 AgriData, Inc.

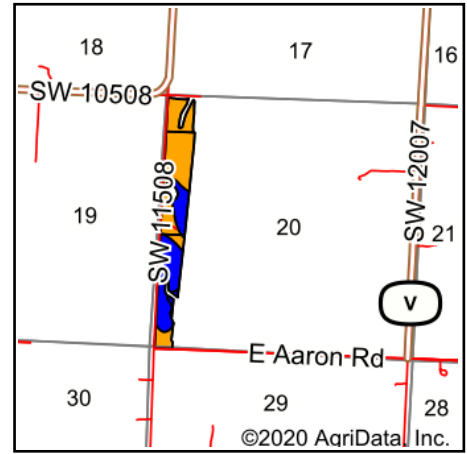

State: **Missouri**
 County: **Bates**
 Location: **20-38N-33W**
 Township: **Howard**
 Acres: **55.11**
 Date: **12/28/2020**



Maps Provided By:



© AgriData, Inc. 2020

www.AgriDataInc.com



Code	Soil Description	Acres	Percent of field	Non-Irr Class Legend	Non-Irr Class *c	Range Production (lbs/acre/yr)	*n NCCPI Overall	*n NCCPI Corn	*n NCCPI Small Grains	*n NCCPI Soybeans	*n NCCPI Cotton
40072	Kenoma silt loam, 1 to 3 percent slopes	32.18	58.4%		Ille	3888	59	56	56	59	54
40066	Hartwell silt loam, 0 to 1 percent slopes	16.22	29.4%		Ilw	0	75	75	59	63	58
40091	Summit silty clay loam, 2 to 5 percent slopes	6.71	12.2%		Ile	0	69	66	58	61	67
Weighted Average						2270.3	*n 64.9	*n 62.8	*n 57.1	*n 60.4	*n 56.8

*n: The aggregation method is "Weighted Average using all components"

*c: Using Capabilities Class Dominant Condition Aggregation Method

Soils data provided by USDA and NRCS.