



Wayne Keller - Auctioneer
800-357-4020

On-Line Real Estate Auction

286+- Acres - 4 Tracts

SOLD!

Info and Bid @ buyafarm.com

Bidding Opens November 7th

Bidding Closes November 12th @ 8:00 PM CST

Location: I-55 to Old Appleton exit. West on KK 1/2 mile to Tract #1 easement. Go another 1/2 mile to County Road 401.
North 1/2 mile to Tracts # 2 and 3. Travel another 1/4 mile to tract #4.



11849 County Farm Road
Steeleville, IL 62288

286+- acre farm in Cape Girardeau Co MO. 177+- tillable acres.
Good quality soils, predominately Menfro. Offered in 4 Tracts,
No combinations. Go to buyafarm.com for more info. Shown by
appointment. Can't or need help to bid on line? Call Auctioneer
Wayne Keller.

Terms: 10% down, close within 45 days, Each tract offered
individually, no combinations. No buyer's commission. See
buyafarm.com for additional details, or call...

Wayne Keller 800-357-4020 MO Auctioneer / Broker
PROPERTY TO SELL? Call an agent with experience.
Wayne has more than 60,000 acres in career sales.

buyafarm.com
800-357-4020

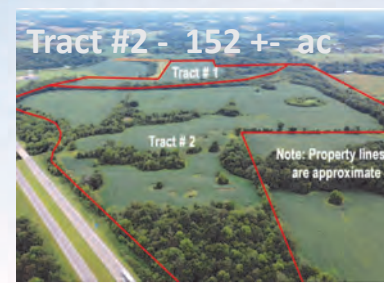

Pt Sec 1, Tsp. 33N - R. 11E & Pt. Sec 6, Tsp 33N—R 12 E Cape Girardeau Co MO