

# Soils Map

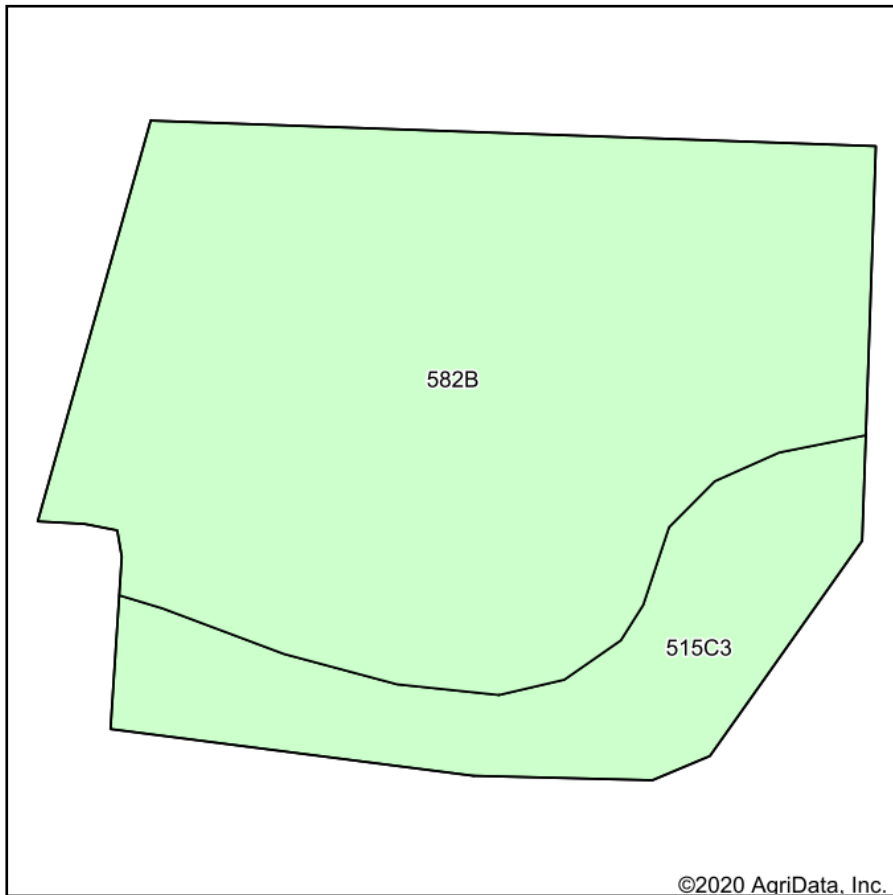

Soils data provided by USDA and NRCS.

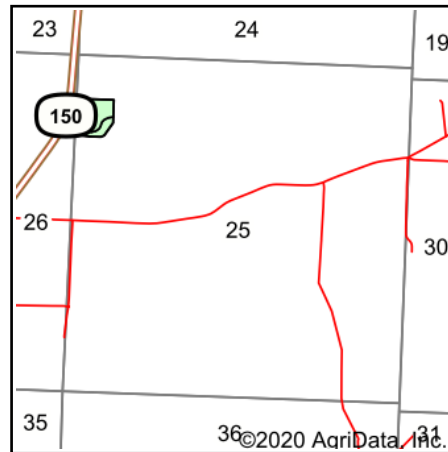

State: **Illinois**  
 County: **Randolph**  
 Location: **25-6S-6W**  
 Township: **Bremen**  
 Acres: **9.19**  
 Date: **8/27/2020**



Maps Provided By:



© AgriData, Inc. 2020

www.AgriDataInc.com



Area Symbol: IL157, Soil Area Version: 14								
Code	Soil Description	Acres	Percent of field	Il. State Productivity Index Legend	Corn Bu/A	Soybeans Bu/A	Wheat Bu/A	Crop productivity index for optimum management
**582B	Homen silt loam, 2 to 5 percent slopes	7.20	78.3%		**149	**47	**55	**108
**515C3	Bunkum silty clay loam, 5 to 10 percent slopes, severely eroded	1.99	21.7%		**126	**43	**48	**95
<b>Weighted Average</b>					<b>144</b>	<b>46.1</b>	<b>53.5</b>	<b>105.2</b>

**Table: Optimum Crop Productivity Ratings for Illinois Soil by K.R. Olson and J.M. Lang, Office of Research, ACES, University of Illinois at Champaign-Urbana.** Version: 1/2/2012 Amended Table S2 B811

Crop yields and productivity indices for optimum management (B811) are maintained at the following NRES web site: <http://soilproductivity.nres.illinois.edu/>

\*\* Indexes adjusted for slope and erosion according to Bulletin 811 Table S3

Soils data provided by USDA and NRCS. Soils data provided by University of Illinois at Champaign-Urbana.