

SOLD 68.73 AC TRACTS 5, 6, & 7 \$238,000 / CLOSED 3/26/19

FOR SALE: 216.11 Surveyed Acres Jefferson County IL Located Northwest of Mt. Vernon IL

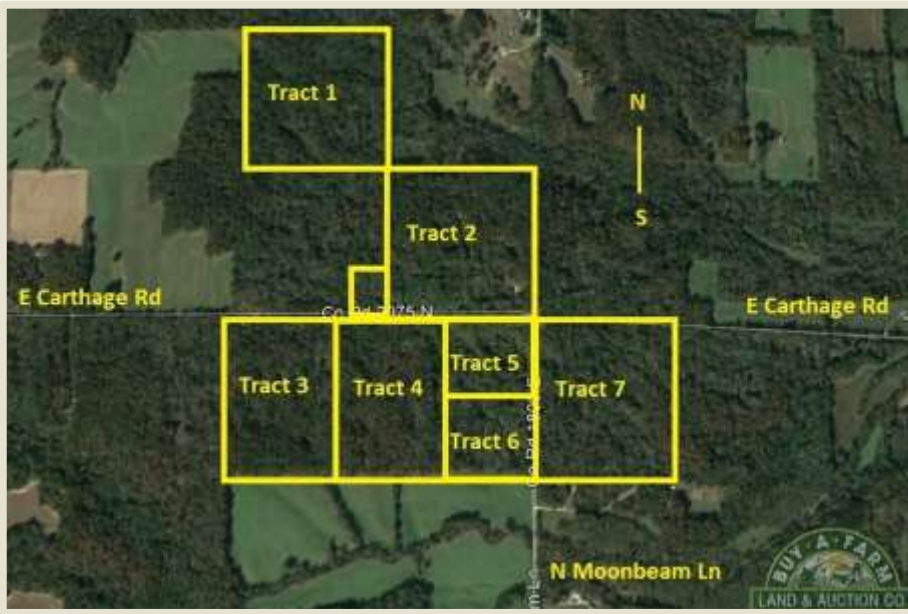

Don Bailey

Managing Broker

Cell: 618-919-1031

dbailey@buyafarm.com

Flora Branch Office

Office: 855-468-3478

301 North Main St, Flora IL



buyafarm.com

PROPERTY DETAILS (2368L)

Address: East Carthage Road, Mt. Vernon IL 62864

List Price: \$750,914

Flat and Rolling Timber Tract

216.11 acres all timber with flat and rolling land. Property is NW of Mt. Vernon IL. Offering some of the best wildlife habit in the area. Can be purchased in separate tracts.

Located in Part of Sections 24 and 13, T1S-R3E.

Specializing in Rural Real Estate Sales and Auctions

MAIN OFFICE: 1403 Hillcrest Drive, Sparta IL 62286 / 800-443-1998