

Aerial Map

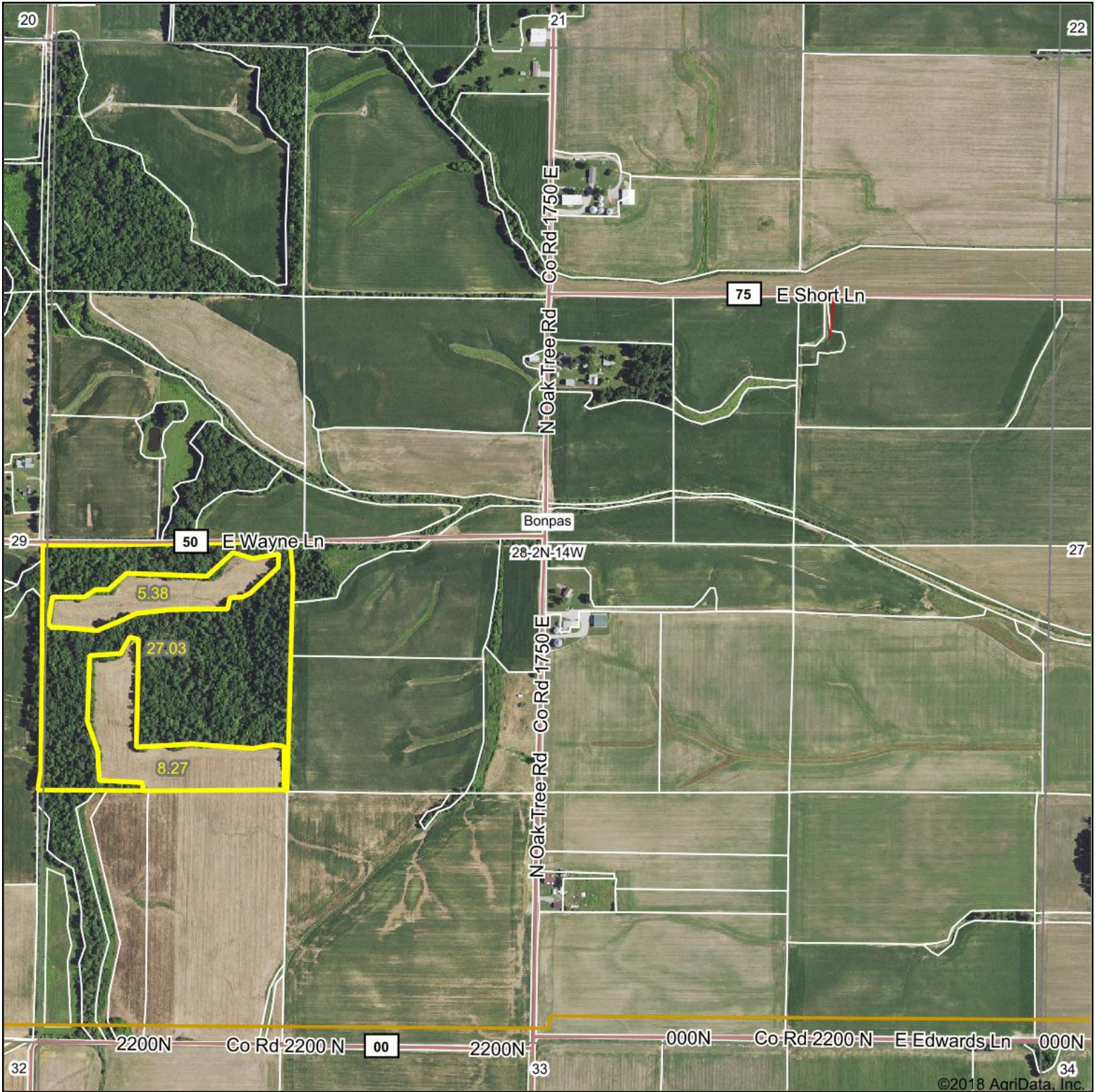

©2018 AgriData, Inc.

map center: 38.577406, -87.975760

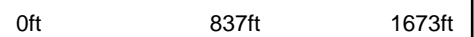

Brett Berger, ARA

28-2N-14W
Richland County
Illinois

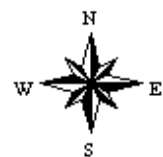

1/8/2019

Maps Provided By:

CUSTOMIZED ONLINE MAPPING
© AgriData, Inc. 2018 www.AgriDataInc.com

Soils Map

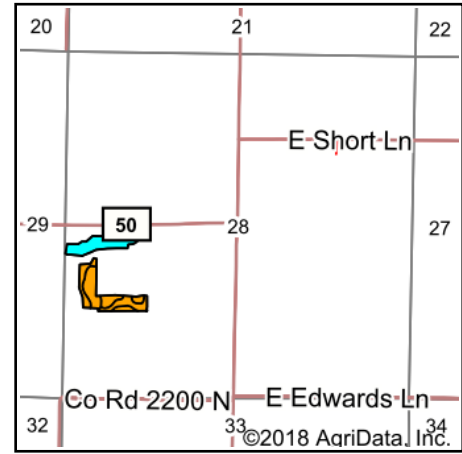
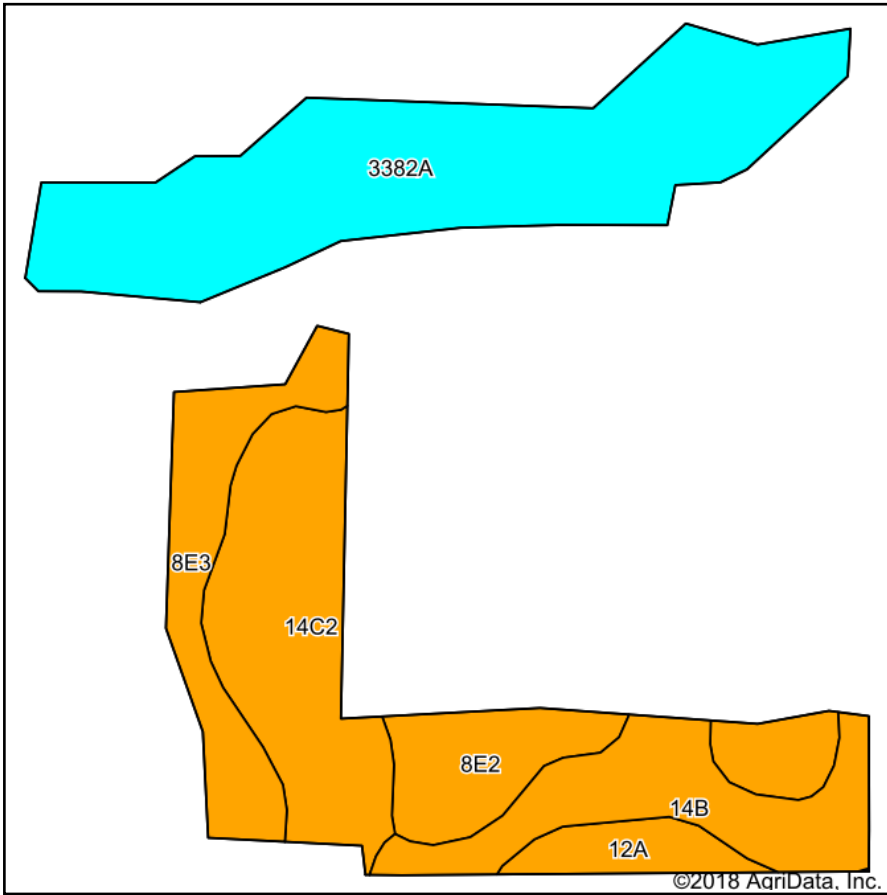

State: **Illinois**
 County: **Richland**
 Location: **28-2N-14W**
 Township: **Bonpas**
 Acres: **13.65**
 Date: **1/8/2019**

 Brett Berger, ARA

Maps Provided By:

 CUSTOMIZED ONLINE MAPPING
 © AgriData, Inc. 2018 www.AgriDataInc.com



Area Symbol: IL159, Soil Area Version: 10







Code	Soil Description	Acres	Percent of field	Il. State Productivity Index Legend	Corn Bu/A	Soybeans Bu/A	Wheat Bu/A	Crop productivity index for optimum management
3382A	Belknap silt loam, 0 to 2 percent slopes, frequently flooded	5.39	39.5%		156	52	63	117
**14C2	Ava silt loam, 5 to 10 percent slopes, eroded	2.70	19.8%		**122	**40	**50	**90
**14B	Ava silt loam, 2 to 5 percent slopes	1.89	13.8%		**134	**44	**54	**99
**8E3	Hickory clay loam, 18 to 25 percent slopes, severely eroded	1.60	11.7%		**82	**28	**33	**63
**8E2	Hickory silt loam, 10 to 18 percent slopes, eroded	1.52	11.1%		**108	**36	**44	**82
12A	Wynoose silt loam, 0 to 2 percent slopes	0.55	4.0%		128	42	51	97
Weighted Average					131.1	43.5	53.1	98.1

Table: Optimum Crop Productivity Ratings for Illinois Soil by K.R. Olson and J.M. Lang, Office of Research, ACES, University of Illinois at Champaign-Urbana. Version: 1/2/2012 Amended Table S2 B811

Crop yields and productivity indices for optimum management (B811) are maintained at the following NRES web site: <http://soilproductivity.nres.illinois.edu/>

** Indexes adjusted for slope and erosion according to Bulletin 811 Table S3

Soils data provided by USDA and NRCS. Soils data provided by University of Illinois at Champaign-Urbana.

*c: Using Capabilities Class Dominant Condition Aggregation Method