

SOLD \$31,000 / CLOSED 1/17/19

FOR SALE: 29.84+- Surveyed Acres Tract 3 Jefferson County IL
Located Northeast of Mt. Vernon IL

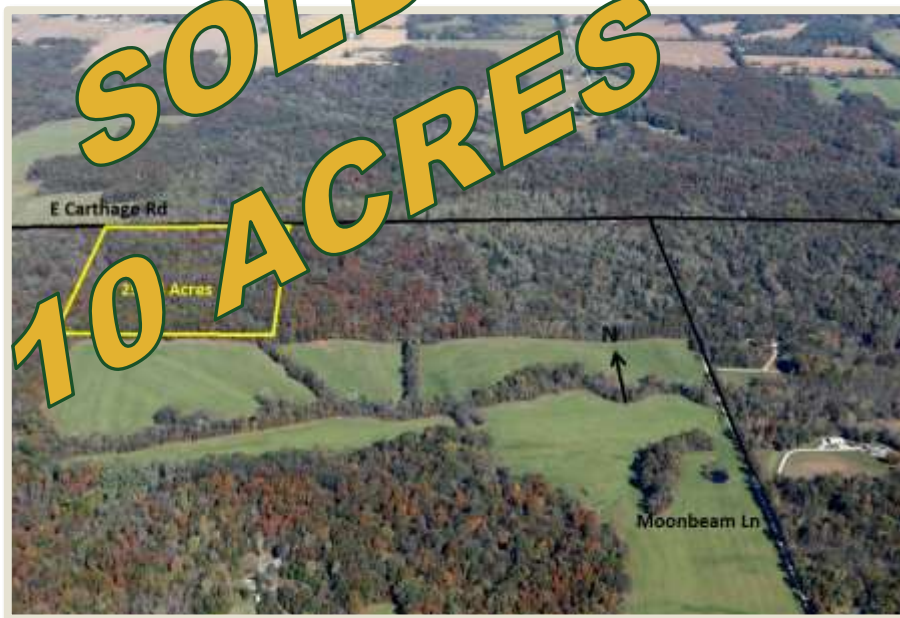

Don Bailey

Managing Broker

Cell: 618-919-1031

dbai-

ley@buyafarm.com

Flora Branch Office



buyafarm.com

PROPERTY DETAILS (2368L)

Address: East Carthage Road, Mt. Vernon IL

List Price: \$107,424

ROLLING TIMBER TRACT

29.84 surveyed acres has timber rolling land. The property is NE of Mt Vernon IL and East of Texico IL and Interstate 57. Ground is located on the south side of East Carthage Road, also known as County Road 2075N, which is now a good road to travel. There is an amazing number of deer and turkey. The property was recently surveyed. This is tract 3 which is part of a 216.11 acres offered in 7 tracts. Tracts range from 15 acres to 47.69 acres and can be purchased together or separately.

Shown by appointment only. Please respect hunting season

Specializing in Rural Real Estate Sales and Auctions
MAIN OFFICE: 1403 Hillcrest Drive, Sparta IL 62286 / 800-443-1998