

Soils Map

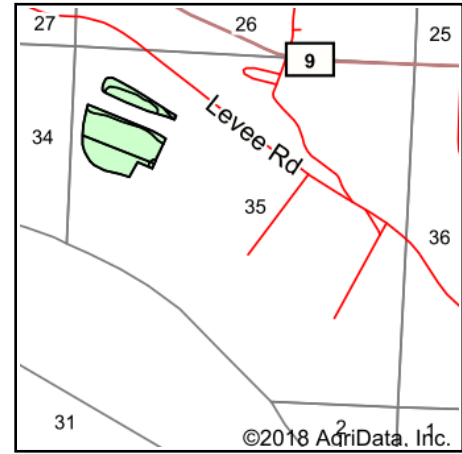

State: **Illinois**
 County: **Jackson**
 Location: **26-9S-4W**
 Township: **Fountain Bluff**
 Acres: **25.75**
 Date: **9/21/2018**

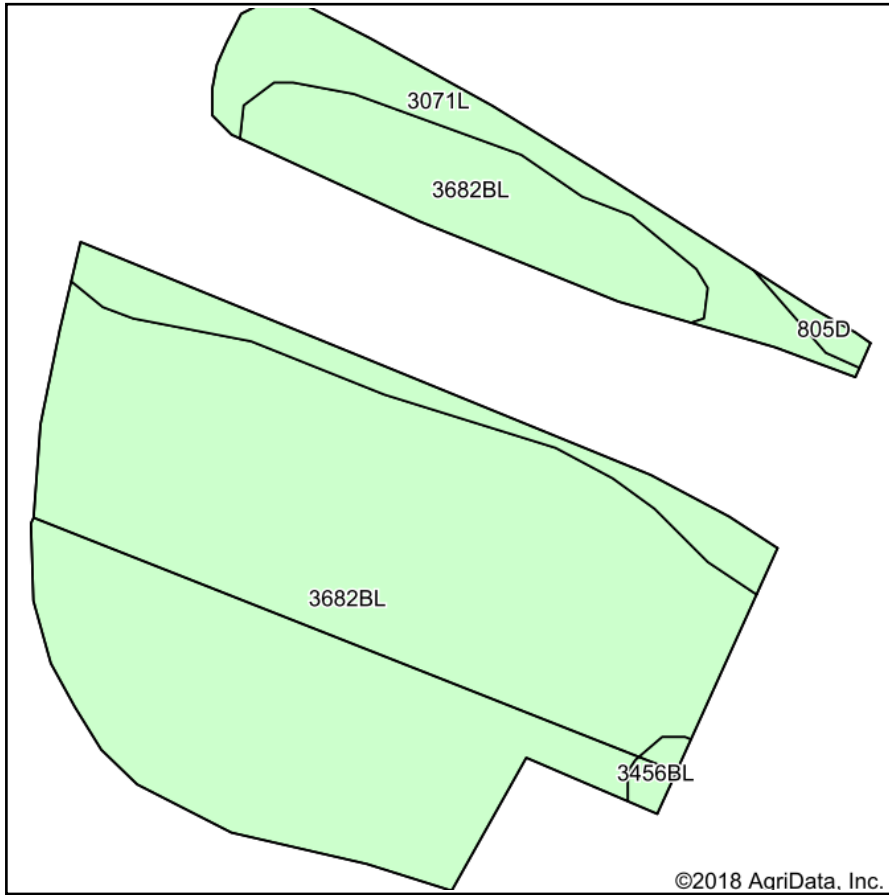

Maps Provided By:



Area Symbol: IL077, Soil Area Version: 17

| Code | Soil Description | Acres | Percent of field | Il. State Productivity Index Legend | Corn Bu/A | Soybeans Bu/A | Wheat Bu/A | Crop productivity index for optimum management |
|-------------------------|--|-------|------------------|-------------------------------------|--------------|---------------|-------------|--|
| 3682BL | Medway silty clay loam, 1 to 6 percent slopes, frequently flooded, long duration | 21.57 | 83.8% | | 176 | 57 | 69 | 131 |
| 3071L | Darwin silty clay, 0 to 2 percent slopes, frequently flooded, long duration | 3.80 | 14.8% | | 149 | 50 | 60 | 111 |
| 3456BL | Ware fine sandy loam, 1 to 6 percent slopes, frequently flooded, long duration | 0.20 | 0.8% | | 159 | 51 | 63 | 118 |
| 805D | Orthents, clayey, sloping | 0.18 | 0.7% | | | | | |
| Weighted Average | | | | | 170.6 | 55.5 | 67.1 | 127 |

Table: Optimum Crop Productivity Ratings for Illinois Soil by K.R. Olson and J.M. Lang, Office of Research, ACES, University of Illinois at Champaign-Urbana. Version: 1/2/2012 Amended Table S2 B811

Crop yields and productivity indices for optimum management (B811) are maintained at the following NRES web site: <http://soilproductivity.nres.illinois.edu/>

** Indexes adjusted for slope and erosion according to Bulletin 811 Table S3

Soils data provided by USDA and NRCS. Soils data provided by University of Illinois at Champaign-Urbana.